

# TUNGSTEN-CARBIDE-TIPPED-HOLE SAWS

# LONG TYPE

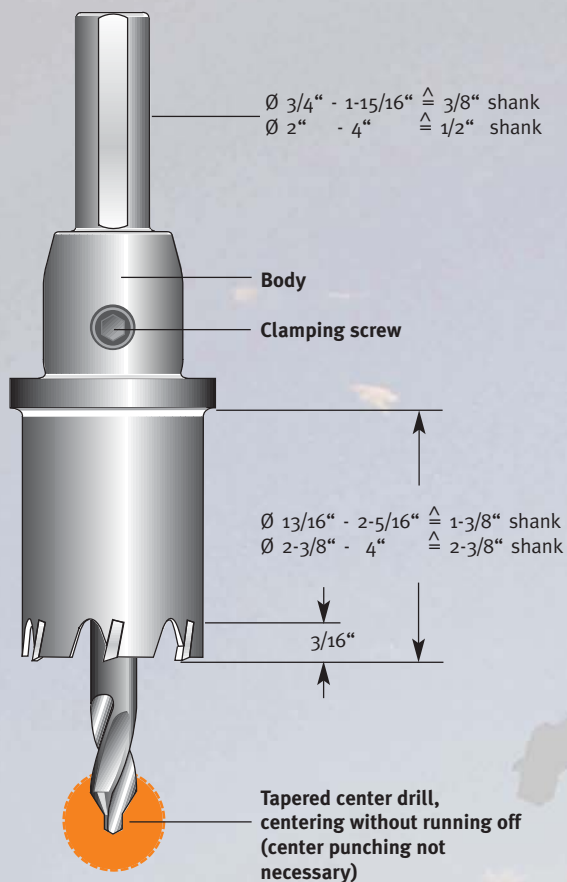

MADE IN GERMANY BY ALFRA



Especially developed for the use on pipes, vaulted materials, for unalloyed and alloyed steels, nonferrous metals, plastics as well as glass fibre reinforced plastic.

- For material thickness up to  $3/16''$ ,  **$1/16''$  stainless steel**
- For the use on hand drilling machines or pillar drilling machines

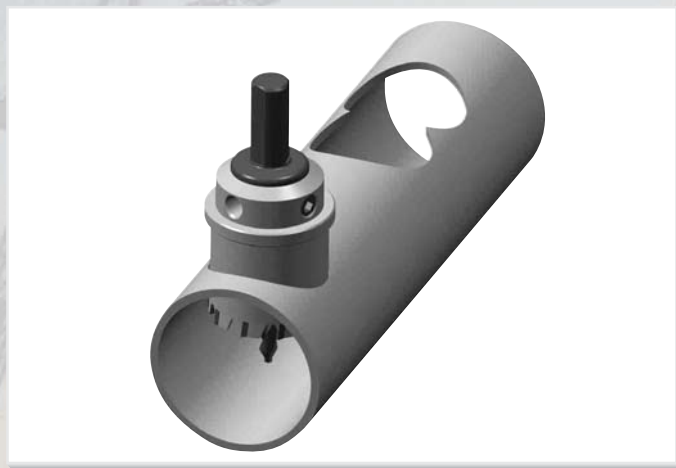

Special tools for special applications on request!

# TUNGSTEN-CARBIDE-TIPPED-HOLE SAWS LONG TYPE

MADE IN GERMANY BY ALFRA

Ø inch	Ø Metric mm	No. of teeth	Prod.-No.
13/16"	20	5	0700200
	21	5	0700210
	22	5	0700220
7/8"	23	5	0700230
15/16"	24	6	0700240
	25	6	0700250
1"	26	6	0700260
1-1/16"	27	6	0700270
	28	6	0700280
1-1/8"	29	6	0700290
	30	6	0700300
1-3/16"	31	8	0700310
1-1/4"	32	8	0700320
	33	8	0700330
1-5/16"	34	8	0700340
1-3/8"	35	8	0700350
	36	8	0700360
1-7/16"	37	8	0700370
	38	8	0700380
1-1/2"	39	8	0700390
1-9/16"	40	10	0700400
	41	10	0700410
1-5/8"	42	10	0700420
1-11/16"	43	10	0700430
	44	10	0700440
1-3/4"	45	10	0700450
	46	10	0700460
1-13/16"	47	10	0700470
1-7/8"	48	10	0700480
	49	10	0700490
1-15/16"	50	12	0700500
2"	51	12	0700510
2-1/16"	52	12	0700520
	53	12	0700530
2-1/8"	54	12	0700540

Ø inch	Ø Metric mm	No. of teeth	Prod.-No.
	55	12	0700550
2-3/16"	56	12	0700560
2-1/4"	57	12	0700570
	58	12	0700580
2-5/16"	59	12	0700590
2-3/8"	60	14	0700600
	61	14	0700610
2-7/16"	62	14	0700620
	63	14	0700630
2-1/2"	64	14	0700640
	65	14	0700650
2-9/16"	66	14	0700660
2-5/8"	67	16	0700670
	68	16	0700680
2-11/16"	69	16	0700690
2-3/4"	70	16	0700700
	71	16	0700710
2-13/16"	72	16	0700720
2-7/8"	73	16	0700730
	74	16	0700740
2-15/16"	75	16	0700750
3"	76	18	0700760
	77	18	0700770
3-1/16"	78	18	0700780
3-1/8"	79	18	0700790
	80	18	0700800
3-3/16"	81	18	0700810
	82	18	0700820
3-1/4"	83	18	0700830
3-5/16"	84	20	0700840
	85	20	0700850
3-3/8"	86	20	0700860
3-7/16"	87	20	0700870
	88	20	0700880
3-1/2"	89	20	0700890

Ø inch	Ø Metric mm	No. of teeth	Prod.-No.
3-9/16"	90	20	0700900
	91	20	0700910
3-5/8"	92	20	0700920
	93	22	0700930
3-11/16"	94	22	0700940
3-3/4"	95	22	0700950
	96	22	0700960
3-13/16"	97	22	0700970
3-7/8"	98	22	0700980
	99	22	0700990
3-15/16"	100	22	0701000
4"	102	22	0701020

## HSS-Spare Drill

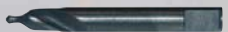
with tapered center tip 

6 x 3-3/16"	0702680
8 x 3-3/16"	0702880
8 x 4"	0702800



As from Ø 1-3/16" we recommend the use of MT2 and MT3 arbors.

MT-2 (up to Ø 3-15/16")	0734002
MT-3 (up to Ø 6")	0734003



## ALFRA Supercut Concentrated

Metall Cutting Fluid for vertical and overhead core drillings, as paste sticks to the cutter

Alfra Supercut 1 U.S. Gallon (3,78 L)	21001
Alfra Supercut 1/4 U.S. Gallon (1 L)	21002



## High-performance wax stick

Ideal for vertical and overhead core drillings, as paste sticks to the cutter

High performance wax stick	09011
----------------------------	-------

